

PUBCO

February 2010

CONCEALED DUAL-FLUSH VALVE MODEL B4H-DF

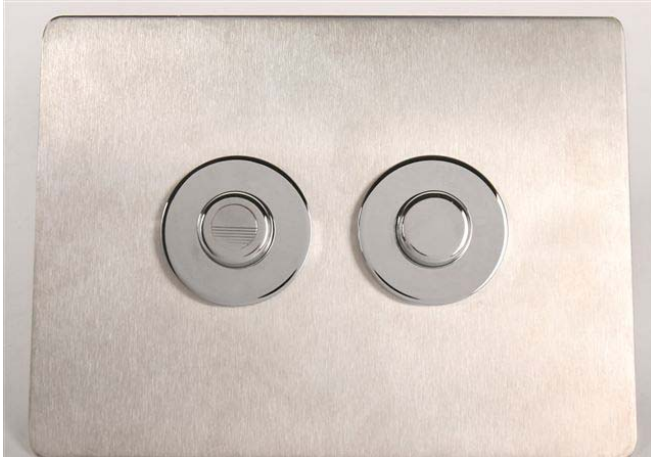

STANDARD FRONT PANEL
BUTTONS 24mm DIA.



SPECIAL LARGER BUTTONS
42mm DIA.

Hydraulically-Operated

Ease of operation and flexibility in push button position.

W WaterMark Level 1 WMKA00335

WELS Licence No.0098

1, 3 and 4 star configurations

Flushing valves for tank fed, independent, flusherette systems. This valve is manufactured in Australia and has been designed to provide many years of reliable operation. It is made from best quality materials with few and inexpensive replacement parts required.

The valve castings are all bronze and the working brass components are DR brass or 304 grade stainless steel.

The front buttons are all brass, bright chrome plated, and the front panel is T304 stainless steel with No.4 polish satin finish. Bright polish is available for this panel.

Concealed Dual Flush Valve Model B4H-DF.....page 2

SPECIFICATIONS

PRESSURE 30 to 300 kPa static pressure.

Pipe sizing must be adequate to provide a minimum flow pressure of 24 kPa.

INLET AND OUTLET CONNECTIONS (40mm nom.)

Inlet thread is 1 ½ inch BSP female and outlet is 1 ½ inch BSP male with compression rubber seal for sealing 1 ½ inch tubing.

Adjustable coupling with the stop valve to give a centre distance of 127 mm +/- 10 mm.



BUTTONS

Buttons are available to suit any wall type from panels to brick or block construction and are supplied to suit a specified type of wall.

The push buttons are approx. 25mm dia. and the surround flange is 50mm dia. The half flush button is identified by a circular “half flush” symbol.

CAVITY SPACE AND ACCESS

Minimum to be 400 x 400 x 200 mm with 130 mm clearance on one side for piston actuator and tubing radius.

Access panels must be 400 x 400 mm minimum to provide workable access.

VOLUME

Volume is adjustable on the dual flush valves but are factory set at the specified volume.

The pipework must have a 1 ½ inch(40 mm nom.) feed line to the valve and the reticulation pipework must be of sufficient size to provide a minimum flow rate of 1.3 litres per second for a 3.0 / 6.0 litre flush, allowing for simultaneous use.

The Pubco dual flush valve is available in volume adjustments of:

4.5 / 9.0 litre	1 star WELS rating
3.0 / 6.0 litre	3 star WELS rating
3.0 / 4.5 litre	4 star WELS rating

RETRO-FITTING

The valve can be fitted to existing flusherette systems with older 9 or 11 litre pans where the flow rate must be 1.4 litres / sec minimum allowing for simultaneous use. In older installations the pipework was usually correctly designed and these considerations usually only apply in the lowest pressure area of the building. On the older pans, a 4.5 / 9.0 litre flush is suitable and will, according to the rating guidelines, result in a 40% reduction in average flush volume (on a 9 litre pan) to 5.4 litres.

The new dual flush valve can be fitted to existing Pubco stop valves and no pipe modifications are necessary. The stop valve spindle should be serviced or replaced. The new dual flush valve and stop valve can generally be fitted to other flusherette valve installations without pipe modification but in all cases, including existing Pubco installations, new wall holes are necessary to fit the new button assembly.

MAINTENANCE

The internal valve components remain similar to the existing Pubco valve and this is an advantage for servicing needs. The actuators are new with the diaphragm only requiring replacement on that type of actuator. The piston actuator is purchased as a unit but these can be serviced by Pubco. The buttons should provide a long life and the cartridge can be purchased or the unit serviced.

All parts are available to purchase or Pubco can service any part in our premises. See Pubco Dual flush maintenance and spare parts brochure.

WARRANTY

There is a 1 year conditional warranty on the flush valve.

PUBCO PRODUCTS AND ENGINEERING

3A SOUTH ST,
(PO BOX 265)

RYDALMERE NSW 2116

T 02 9684 2182

F 02 9638 2764

E-mail sales@pubco.com.au

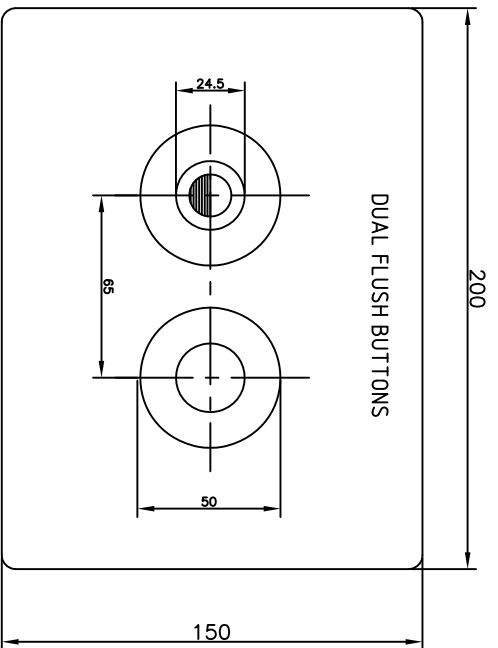
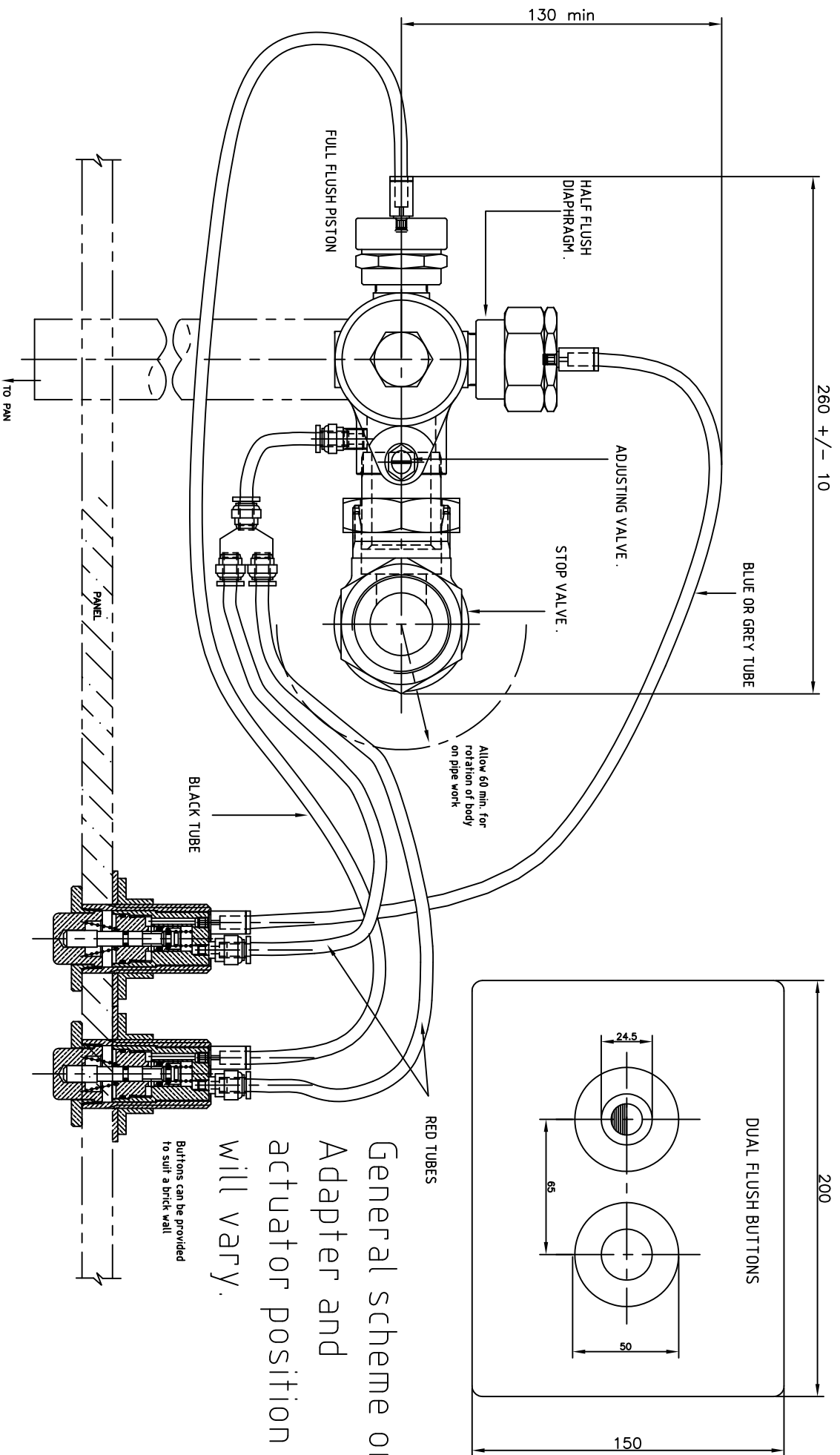

General scheme only.
 Adapter and
 actuator position
 will vary.

Buttons can be provided
 to suit a brick wall

Title		Drawn by		Checked by		Origination_Date		Issue Date		Scale	
CONCEALED DUAL FLUSH VALVE		RWN						06/08/09		NTS	
MATERIAL		Pubco Products and Engineering									
		3A South Street, Rydalmere, NSW 2116									
		Ph: (02) 9684 2182, Fax: (02) 9638 2764									
Issue No		Revision note		Date		Issued by		Approved		Sheet	
1										1/1	